

RESOLUTION 91-166

A RESOLUTION OF THE MAYOR AND COMMON COUNCIL OF THE TOWN OF CAMP VERDE YAVAPAI COUNTY, ARIZONA, TO RECEIVE TRAIL AND PUBLIC RECREATIONAL EASEMENTS ON PARCELS OF LAND OF THE PRESCOTT AND COCONINO NATIONAL FORESTS

WHEREAS, the Town has declared in Resolution 90-106 its policy to accept trails across federal property for public equestrian and recreational use, and

WHEREAS, three specific parcels of property as set forth in Exhibits A and B will be incorporated herein and have been identified as base for exchange or other disposal by the Prescott and/or Coconino National Forest within the Town limits that would be adaptable for placement of a trail for access to remaining public lands, connection to private and public established trails, and access to riparian or other recreational areas,

NOW THEREFORE BE IT RESOLVED AND ORDERED by the Mayor and Town Council of Camp Verde, Arizona:

1. Identification of Easements. The Prescott and Coconino National Forests, USDA, are requested with the cooperation of the VVHC and Town Parks and Recreation Department, to identify trail locations on the parcels, their widths, and potential recreational uses, and to cause such trails to remain as public recreational easements, pursuant to ARS 33-271 and related sections of law, whenever the parcels are exchanged, abandoned, sold, or otherwise removed from public ownership.

2. Acceptance of Easement. The Town agrees to accept the recreational easements for public use, within Town limits, for the purposes declared in the respective instruments.

3. Maintenance. Maintenance of the trails, including posting for any restricted uses, will be done by the Town once the trails and easements have been identified and the property transfers from ownership of the National Forests. Pursuant to ARS 33-1551, as amended, the Town will not be liable for injury to persons or property caused by any act of a recreational user, and permission by the public to enter the easement does not extend any assurance to any recreational user that the premises are safe for such entry or use.

PASSED AND ADOPTED BY THE TOWN OF CAMP VERDE THIS 15TH DAY OF OCTOBER, 1991



Woodrow Diehl, Mayor

ATTEST:

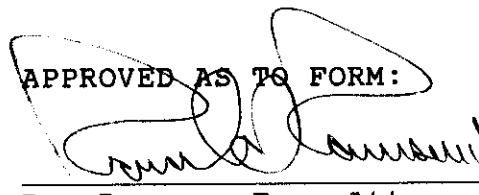

Dane Bullard, Town Clerk

APPROVED AS TO FORM:

Ron Ramsey, Town Attorney

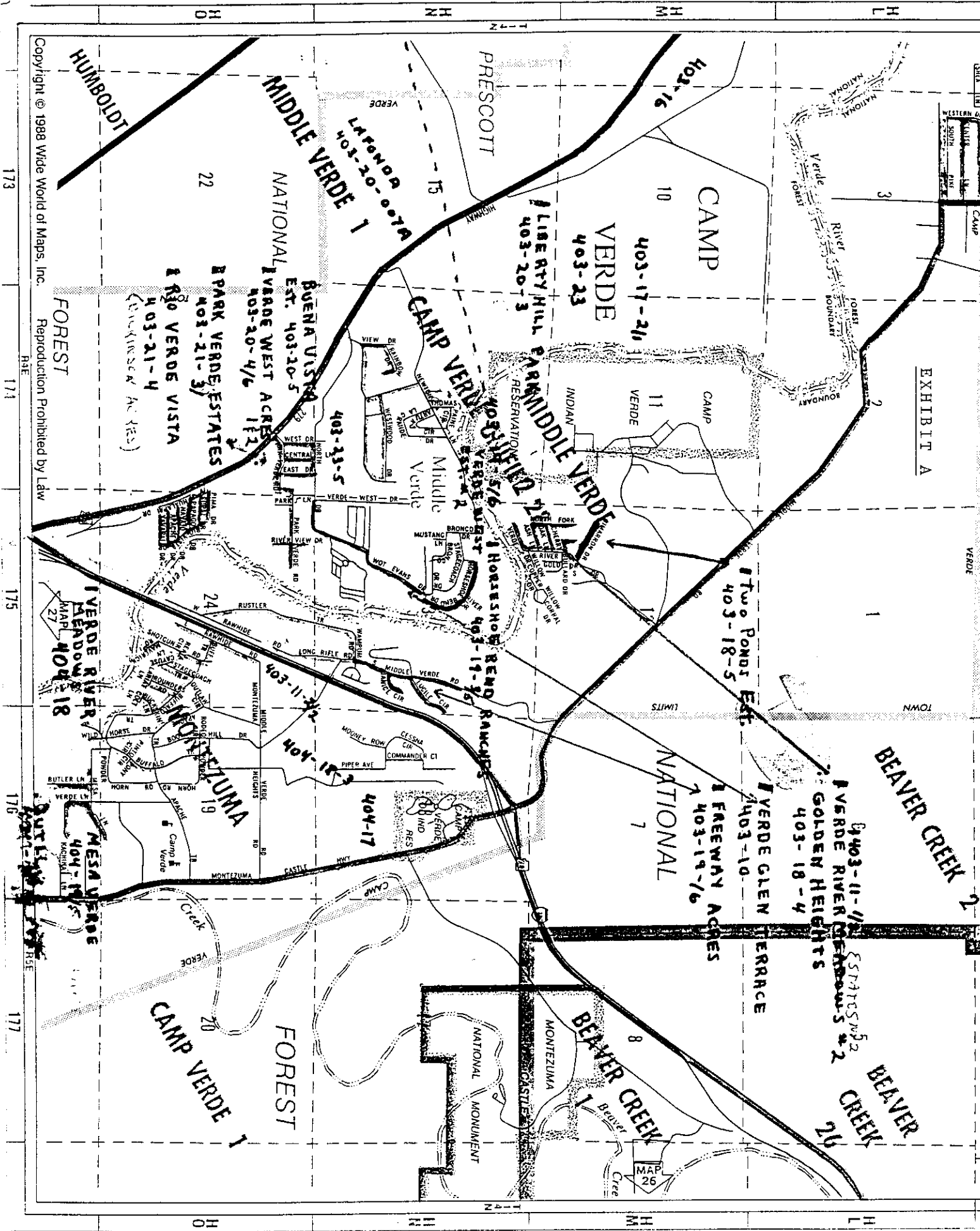

EXHIBIT A

MAP 26

Copyright © 1988 Wide World of Maps, Inc. Reproduction Prohibited by Law

173 174 175 176 177

NMOT

BEAVER CREEK 2

403-11-4/5 ESTATES #2
VERDE RIVER ESTATES #2
GOLDEN HEIGHTS
403-18-4

BEAVER CREEK 26

VERDE GLEN TERRACE
403-10

FREEMAN ACRES
403-19-16

TWO PONDS EST.
403-18-5

NATIONAL 7

BEAVER CREEK 1

MONTAZUMA

NATIONAL MONUMENT

BEAVER CREEK

FOREST

CAMP VERDE 1

CAMP VERDE
403-17-21/1

VERDE
403-23

LIBERTY HILL
403-20-3

CAMP VERDE
RESERVATION #2

MIDDLE VERDE

MIDDLE VERDE 1
403-20-007A

PARK VERDE ESTATES
403-21-3/

PARK VERDE VISTA
403-21-4

FOREST

VERDE RIVER MEADOWS
MAP 404-18

MONTAZUMA

MESA VERDE
404-18/5

HUMBOLDT

PRESCOTT

Verde River
NATIONAL FOREST
BOUNDARY

VERDE

LIMITS

404-17

403-11-3/4

404-15-3

24

22

10

11

3

2

1

8

26

H O

H N

H M

H L

1-42

1-42

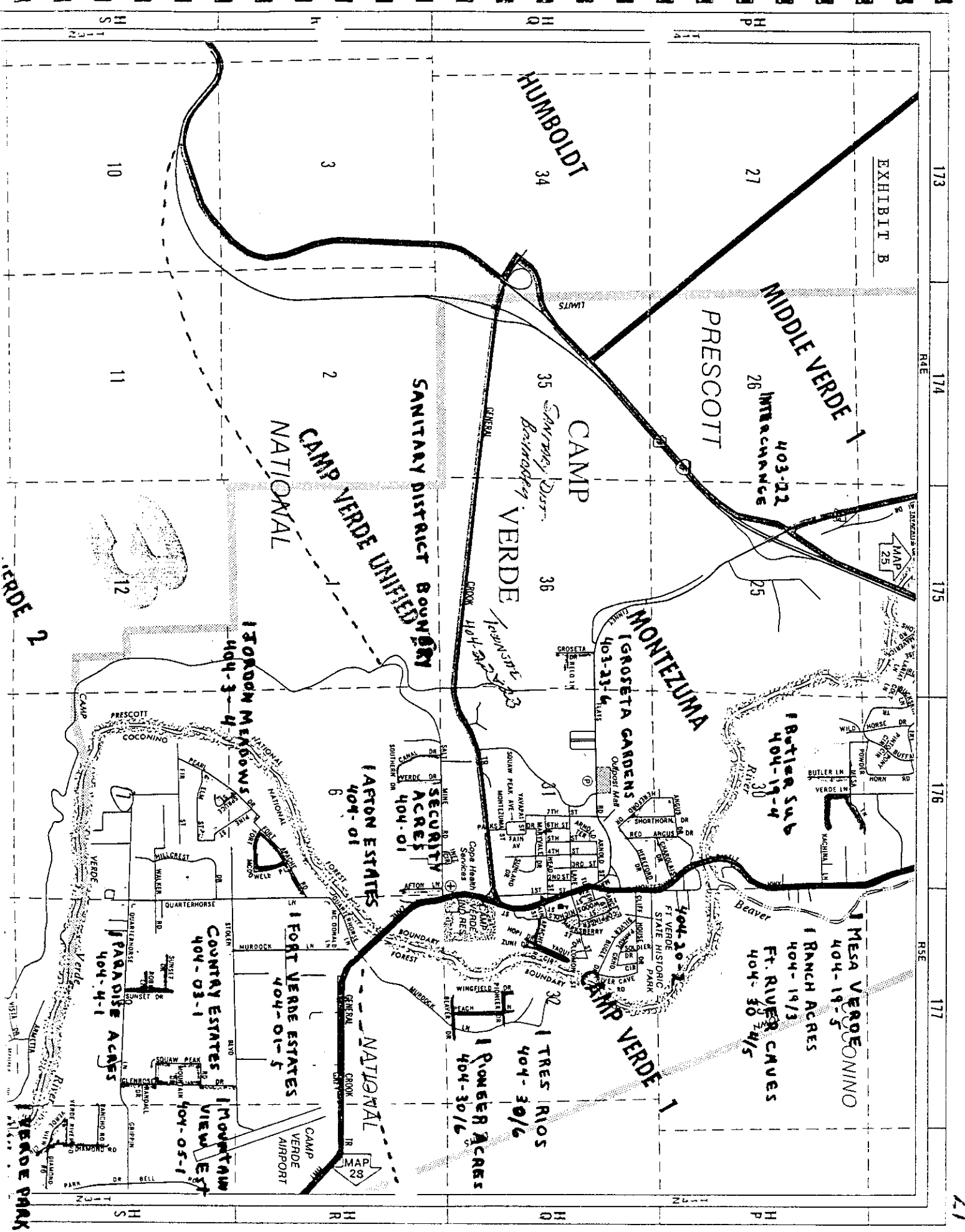

EXHIBIT B

MIDDLE VERDE 1
403-22
26 INTERCHANGE

PRESCOTT

HUMBOLDT
34

CAMP
35 *Santry Dist.*
36 *Barndashy*
VERDE

SANITARY DISTRICT BOUNDARY
CAMP VERDE UNIFIED NATIONAL

MONTAZUMA
403-23-4
GROSETTA GARDENS
1 GROSETTA GARDENS

1 BUTLER SUB
404-19-4

1 MESA VERDE COCONINO
404-19-5
1 RANCH ACRES
404-19/3
1 FT. RIVER CAVES
404-30 2/3

1 AFTON ESTATES
404-01

1 POWER R ACRES
404-30/6

1 TRES RIOS
404-30/6

1 FORT VERDE ESTATES
404-01-5

1 COUNTRY ESTATES
404-03-1

1 PARADISE ACRES
404-4-1

VERDE 2

173 174 175 176 177